

# Compact Bag Filter **BFCI**

**NEW**

- This unit is equipped with a cartridge filter that can handle fine ceramic dust, and demonstrates superior collection efficiency.
- The filter cleaner is a pulse jet type (differential pressure detection). It enables reliable, continuous operation with low power consumption.
- The cartridge filter is detachable from the front side and easy to inspect and replace.
- The collected dust is collected in a dust bag fitted inside the dust tank. This prevents dust from scattering and makes dust disposal easy.

## Dimensional drawing

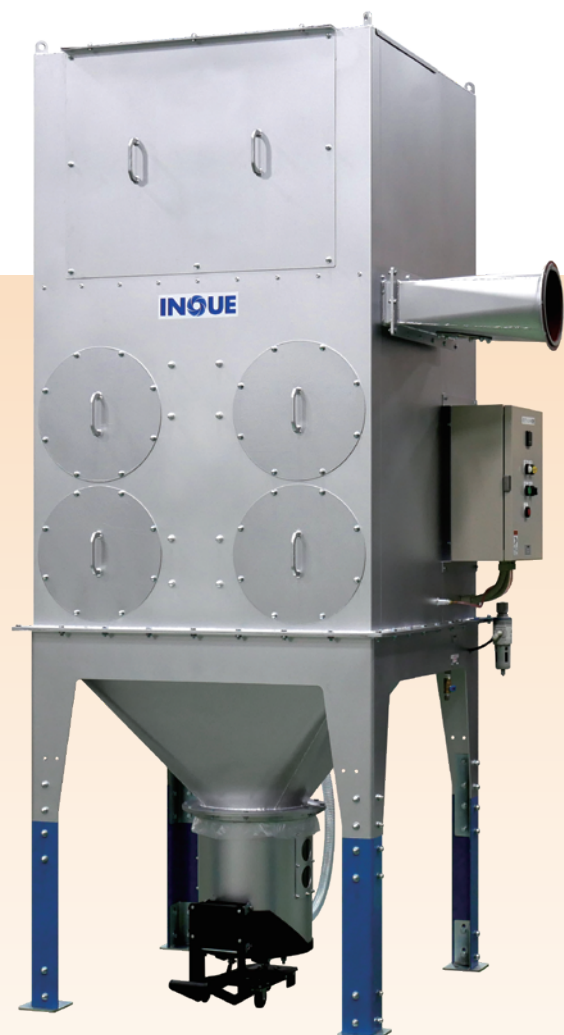
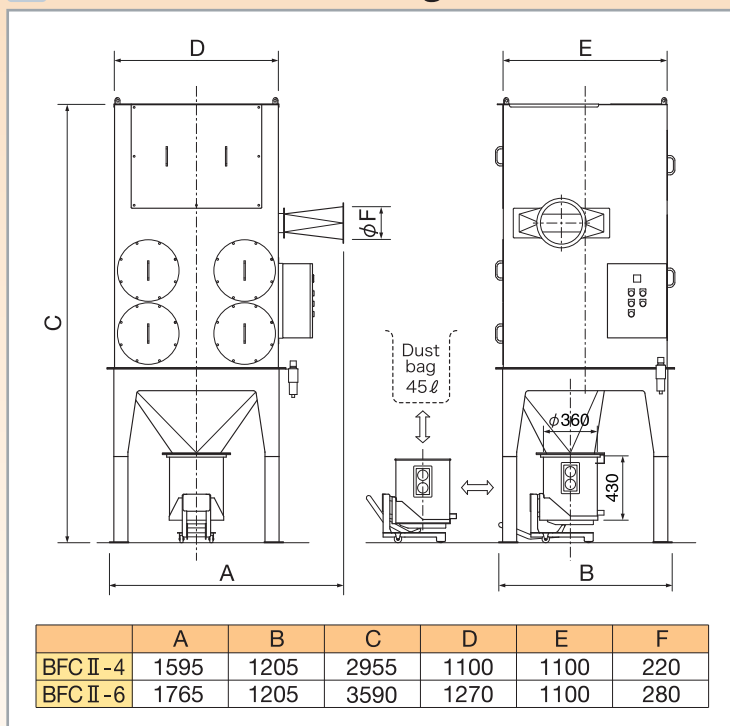

**BFCI-4**

## Specifications

Model		BFC II -4			BFC II -6		
Fan	Motor output      kW	3.7			5.5		
	Airflow rate    m³/min	35	50	60	55	75	85
	Pressure        kPa	3.1	2.9	2.5	3.2	2.9	2.5
	Intake diameter   mmφ	220			280		
Filter	Area             m²	80			120		
	Quantity	4			6		
	Type	Molded cartridge					
	Cleaning	Automatic pulse jet (differential pressure detection)					
Compressed air	Consumption    ℓ/min	40			60		
	Specifications	0.5MPa   PT3/8   φ 10 Air hose connection					
Solenoid valve	Quantity	4			6		
Dust tank	ℓ	25			25		
Weight	kg	700			900		