

 **Satisfactory suction power with low power consumption**

Compact Bag Filter BFAQ

- With a highly efficient turbofan directly connected to the motor, and a unique filter mechanism, this unit is compact, but provides satisfactory suction power.
- Equipped with an antistatic filter as standard, stable suction power is maintained even when collecting dust such as resin, fiber waste, and paper dust.
- The dust removing device attached to the inner surface of the filter is available in electric V type (0.2 kW) or manual S type.
- The standard type collects dust in a transparent dust bag that allows the amount of collected dust to be checked at a glance, and is easy to attach and remove.
- The H type, which connects the air feed duct to the hopper, and the R type, which connects the rotary valve, are ideal for processing bulky cutting waste.
- The Q container can automatically discharge the collected cutting waste via a suction duct. It is very useful in improving the dust operation of attaching and detaching the dust bag.
- When used in combination with a fan shredder, the volume of bulky tape and cutting waste can be reduced.



BFQ7V
Automatic shaking type V

Dimensional drawing

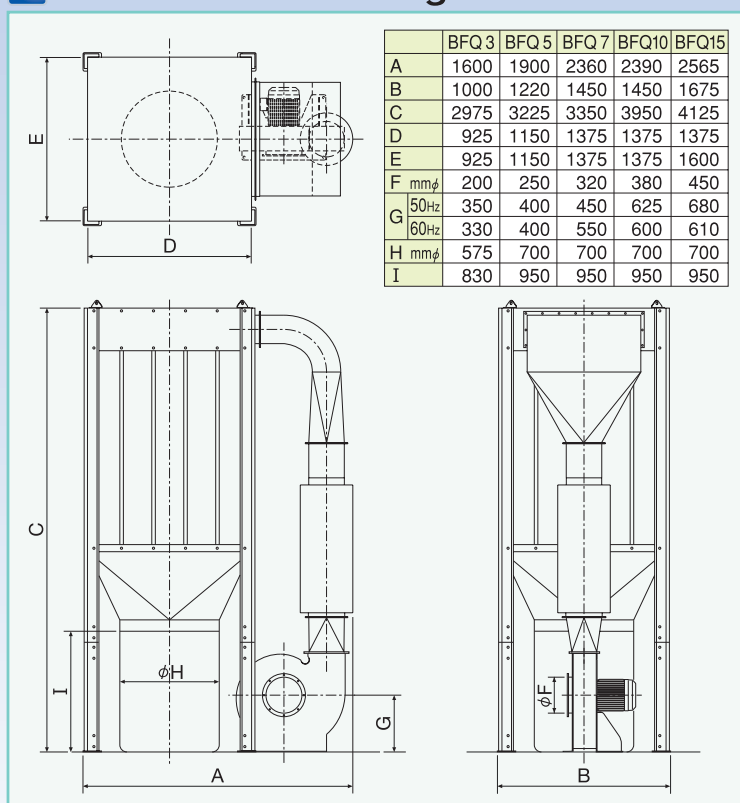

Manual shaking type S



Hopper type H



Q container
Patented

Specifications



Model	BFQ 3	BFQ 5	BFQ 7	BFQ 10	BFQ 15
Motor output kW	2.2	3.7	5.5	7.5	11
Airflow rate m³/min	25~45	40~75	60~110	90~155	120~200
Intake diameter mmφ	200	250	320	380	450